

## Rivets

### Blind rivet nuts for BRN50

Item no.	777203	777204	777205	777206	777207	777208
Name	M4	M5	M6	M8	M10	M12
Dimensions	6.0 × 11.0 mm	7.0 × 11.5 mm	9.0 × 15.5 mm	11.0 × 17.0 mm	12.0 × 17.5 mm	15.9 × 23.0 mm
Material	steel	steel	steel	steel	steel	steel
QTY	25 pcs.	25 pcs.	25 pcs.	10 pcs.	10 pcs.	5 pcs.



### Rivet screws for BRN50

Item no.	777247	777267		777246
Name	M6	M8		SelfLock
Ø	6 mm	8 mm		6 mm
Material	steel	steel		steel
QTY	10 pcs.	10 pcs.		10 pcs.



### Blind rivets

Item no.	777227	777228	777229	777231	777230	777215	777216	777217
Name	blind rivet 4 × 6	blind rivet 5 × 6	blind rivet 6 × 8	blind rivet 6 × 10	blind rivet RIBE	blind rivet AUDI	blind rivet BMW	blind rivet BMW
Dimensions	4.0 × 6.0 mm	5.0 × 6.0 mm	6.0 × 8.0 mm	6.0 × 10.0 mm	6.5 × 12.5 mm	6.5 × 15.0 mm	6.5 × 14.0 mm	6.5 × 16.0 mm
Material	aluminium	aluminium	aluminium	aluminium	galvanized	steel	steel	steel
BR20	X	X	X	X				
BR50	X	X	X	X	X	X	X	X
QTY	40 pcs.	40 pcs.	40 pcs.	40 pcs.	25 pcs.	10 pcs.	10 pcs.	10 pcs.



### Temporary fasteners

Item no.	577108	577104	577109	577106	577107	577110
Ø	2.5 mm	4.1 mm	4.7 mm	6.0 mm	6.35 mm	8.0 mm
QTY	20 pcs.	20 pcs.	20 pcs.	30 pcs.	20 pcs.	20 pcs.



**Note:** When using Flow Form Rivets (FFN) and Countersunk Flow Form Rivets (SFFN), the description of the working process and the application areas of the corresponding repair instructions of the vehicle manufacturer (OEM) must be observed. In principle, a test rivet must always be installed whenever the material or the material thickness is changed. This is the only way to ensure a reliable riveting process. This applies to all rivets from the WS Wieländer+Schill range.



## Self-piercing rivets



Ø D2	3.3 mm				5.3 mm							
Material	steel				steel							
L1 (mm)	3.5	4.0	5.0	6.0	4.0	5.0	6.0	6.5	7.0	7.5	8.0	9.0
K1 (mm)	1.5-2.5	2.5-3.5	3.0-4.0	4.0-5.0	2.0-3.0	3.0-4.0	4.0-5.0	4.5-5.5	5.0-6.0	5.5-6.5	6.0-7.0	7.0-8.0
Item no.	777218	777200	777225	777222	777202	777219	777221	777224	777226	777223	777201	777199
QTY	100 pcs.	100 pcs.	100 pcs.	100 pcs.	200 pcs.	100 pcs.	100 pcs.	100 pcs.	100 pcs.	100 pcs.	100 pcs.	100 pcs.

## Flow-form rivets (10 pcs.)

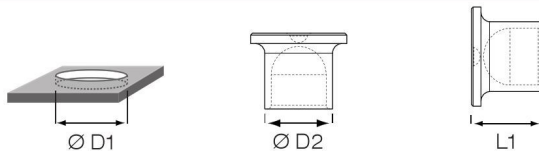

Ø D1	6.0 mm										
Ø D2	5.6 mm										
Material	steel							aluminium			
L1 (mm)	6.9	8.1	9.3	10.6	12.6	13.8	15.0	8.1	9.3	10.6	
Name	S0	S1	S2	S3	S4	S5	S6	A1	A2	A3	
Item no.	777232	777212	777213	777214	777233	777234	777235	777209	777210	777211	

Ø D1	8.0 mm							
Ø D2	7.4 mm							
Material	steel							
L1 (mm)	8.0	9.2	10.4	11.4	12.6	13.8	15.0	
Name	S08	S18	S28	S38	S48	S58	S68	
Item no.	777260	777261	777262	777263	777264	777265	777266	

## Countersunk flow-form rivets (10 pcs.)

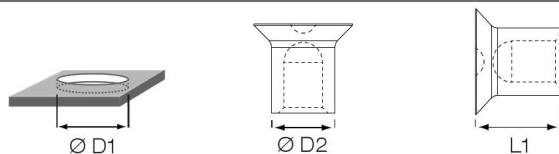

Ø D1	6.0 mm							
Ø D2	5.7 mm							
Material	steel							
L1 (mm)	5.8	7.8	9.0	10.1	11.5	12.9	13.9	
Name	CS0	CS1	CS2	CS3	CS4	CS5	CS6	
Item no.	777304	777300	777301	777302	777303	777305	777306	



## RivBox N° 1 - assortment box standard

Item no. 777281

Scope of delivery:

### self-piercing rivets:

100 × 3.3 × 3.5 mm  
 100 × 3.3 × 4.0 mm  
 200 × 5.3 × 4.0 mm  
 100 × 5.3 × 5.0 mm  
 100 × 5.3 × 6.0 mm

### flow-form rivets:

20 × ALU 5.6 × 8.1 mm A1  
 10 × ALU 5.6 × 9.3 mm A2  
 10 × ALU 5.6 × 10.6 mm A3  
 10 × steel 5.6 × 8.1 mm S1  
 10 × steel 5.6 × 9.3 mm S2  
 10 × steel 5.6 × 10.6 mm S3

### blind rivets:

40 × ALU 5.0 × 6.0 mm  
 40 × ALU 6.0 × 8.0 mm  
 20 × BMW 4.0 × 10.0 mm  
 20 × BMW 4.0 × 12.0 mm  
 20 × RIBE 6.5 × 12.5 mm

### blind rivet nuts:

25 × steel M6 × 9.0 × 15.5 mm  
 10 × steel M8 × 11.0 × 17.0 mm  
 5 × steel M12 × 15.9 × 23.0 mm

### 1 × Special Center Punch

with 2 functions for self-piercing rivets



## RivBox N° 2 - assortment box flow-form rivets

Item no. 777282

Scope of delivery:

### flow-form rivets:

10 × FFN / FFR ALU 5.6 × 8.1 mm A1  
 10 × FFN / FFR ALU 5.6 × 9.3 mm A2  
 10 × FFN / FFR ALU 5.6 × 10.6 mm A3  
 10 × FFN / FFR steel 5.6 × 8.1 mm S1  
 10 × FFN / FFR steel 5.6 × 9.3 mm S2  
 10 × FFN / FFR steel 5.6 × 10.6 mm S3  
 10 × FFN / FFR steel 5.6 × 12.6 mm S4  
 10 × FFN / FFR steel 5.6 × 13.8 mm S5  
 10 × FFN / FFR steel 5.6 × 15.0 mm S6  
 10 × FFN / FFR steel 7.4 × 8.0 mm S08  
 10 × FFN / FFR steel 7.4 × 9.2 mm S18  
 10 × FFN / FFR steel 7.4 × 10.4 mm S28  
 10 × FFN / FFR steel 7.4 × 11.4 mm S38  
 10 × FFN / FFR steel 7.4 × 12.6 mm S48  
 10 × FFN / FFR steel 7.4 × 13.8 mm S58  
 10 × FFN / FFR steel 7.4 × 15.0 mm S68



## RivBox N°3 - assortment box

Item no. 777283

Scope of delivery:

### countersunk flow-form rivets:

50 × SFFN / CFFR CF0  
 50 × SFFN / CFFR CF1  
 50 × SFFN / CFFR CF2  
 50 × SFFN / CFFR CF3  
 50 × SFFN / CFFR CF4

### flow-form rivets:

50 × FFN / FFR S0  
 50 × FFN / FFR S1  
 50 × FFN / FFR S2  
 50 × FFN / FFR S3  
 50 × FFN / FFR S4

### 1 × Special Center Punch

with 2 functions for self-piercing rivets



## Punching crowns SKR

Ø mm	6.0	6.7	8.0
Item no.	700141	700142	700140
QTY	50 pcs.	50 pcs.	50 pcs.

